

# Vector profile rib and rib extra



The new patented  
master key system profiles

**ZIKON**  
ASSA ABLOY

IKON – The locking system specialist since 1926!

ASSA ABLOY, the global leader  
in door opening solutions

# An IKON mechanical locking system: A worthwhile investment in your safety and security

IKON mechanical locking systems impress due to their reliable technology, perfect precision, optimum quality and proven long life cycle. This also applies for the successor profiles in the special class SK6 Vector rib and rib extra:

The **vector profile rib** has a high-quality rib profile with six active spring-mounted pin tumblers. The profile match of the key is arranged parallel to the back of the key. The respective profile characteristics are arranged horizontally in pairs and at an angle to each other and form matched pairs. Manual opening techniques are severely hampered with this special arrangement. A shape scanning pin in the locking cylinder also checks the encryption on the key.

An additional locking pin queries the one-sided rib. In comparison with conventional key profiles, it is distinguished by high security against break-ins, scanning and lock picking.

The key of the **Vector profile rib extra** has an additional rib wave encryption that is scanned by up to five additional, active shoulder pins in the locking cylinder. This type of control on the side of the key profile ensures there are more options for combining and organising systems and also provides even greater protection against lock picking and key copying.

+CLIQ is a mechatronic locking system for upgrading IKON mechanical locking systems.

## The option for higher demands: Upgrading with +CLIQ

*Situations may arise where your mechanical locking system requires reinforcement from mechatronic components. Such situations could include a higher security level being required for sensitive areas in your building or the need for greater flexibility for access authorisations.*

*The +CLIQ technology from the IKON brand is available here. This system integrates chip technology into mechanical locking cylinders and their corresponding keys. As a result, access or locking is controlled on two levels: by mechanical locking and through electronic identity.*



These colour pins will help you identify the allocation of the keys. That makes it much easier to manage keys.

## A wide range of colour pins is available as an option

### RAL colours for colour clips

● RAL 9004   Signal black	● RAL 7047   Telegrey 4	● RAL 6026   Opal green
● RAL 1036   Bronze	● RAL 3031   Orient red	● RAL 8017   Chocolate brown
● RAL 6032   Signal green	● RAL 5017   Traffic blue	● RAL 3015   Light pink
○ RAL 9010   Pure white	● RAL 1018   Zinc yellow	● RAL 5012   Light blue
● RAL 4003   Heather violet	● RAL 2004   Signal orange	● RAL 4005   Blue lilac

## Vector profile rib – Security class 1:

Eight (six + two) tumblers

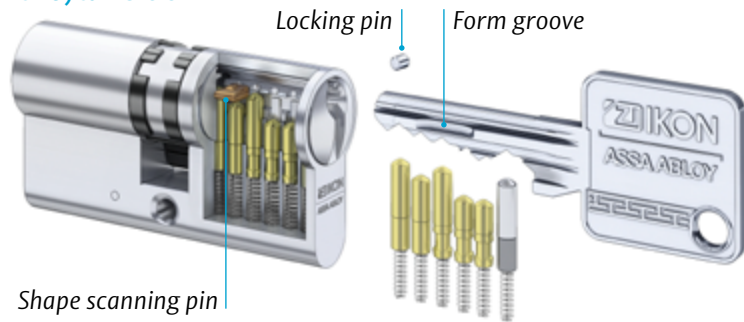

The profiles Vector rib and rib extra can be used combined in one master key system.

## Vector profile rib extra – Security class 2:

12 (6+5+1) tumblers

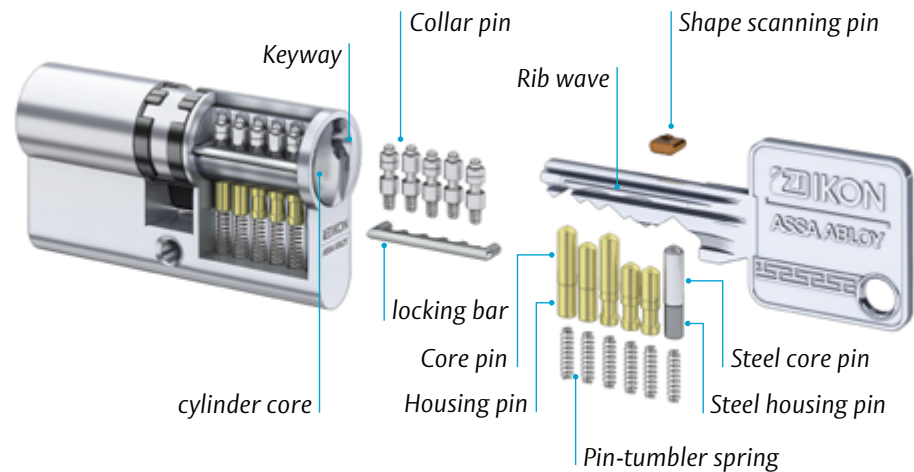

In a locking system, keys from security class 2 also lock cylinders from security class 1.

## The benefits at a glance:

- High-quality and patented key system for GH, H, KHZ, Z and ZUE master key systems
- Highly capable and complex locking system with uncomplicated management
- Very high security against break-ins, scanning and copying with:
  - paracentric vector profile with additional rib
  - lateral shape scanning pin
  - up to 5 active collar pins for scanning of the rib shaft (security class 2)
- Copying prevented with lateral shape scan, rib, rib shaft (security class 2) scan
- Functional options like emergency coupling, panic free wheel FZG, ANTI-AMOK
- Extensive range of models
- Optional highest VdS and DIN classifications
- Upgrade with CLIQ technology possible
- Keys available with integrated transponder
- Fast and easy ordering
- Simple master key system management
- Reliable technology, perfect precision, high quality and proven long life cycle.
- High quality and stable nickel silver key with optional colour pins

ASSA ABLOY is the global leader in door opening solutions, dedicated to satisfying end-user needs for security, safety and convenience



ASSA ABLOY  
Sicherheitstechnik GmbH

Attilastraße 61 – 67  
12105 Berlin  
Germany  
Tel. + 49 30 8106-0  
berlin@assaabloy.com

[www.assaabloy.de](http://www.assaabloy.de)